

Port Canal Shopping Centre

Rich in history, culture and opportunity



discover its charm



Your Centre for Convenient Shopping - Open 7 Days
200 Commercial Road, Port Adelaide SA 5015
p 8240 0844 www.portcanalshoppingcentre.com.au

Centre Overview

Port Canal Shopping Centre is positioned within the heart of one of Adelaide's oldest, historical ports, Port Adelaide. It is a unique shopping centre positioned to meet the everyday needs of its community, and like the Port is rich in history, culture and opportunity. The Centre is located on Commercial Road, and is a 5 minute walk from the Port River. It is surrounded by some of the finest historic landmarks and buildings, and with a solid industrial and residential base the centre provides everyday services and needs to a growing population of over 105,000 residents and over 7000 businesses.

Port Canal Shopping Centre is approximately 12.5 km northwest of the CBD and has already begun to become part of a monumental development project (Newport Quays) situated near the waters edge in bringing new life to the Port.

Centre Facts

| | |
|----------------|---------------------------|
| Centre Type: | Sub-Regional |
| Total GLA: | 19,079.45 sqm |
| Major Tenants: | Coles, Kmart & Woolworths |
| Specialties: | 30 |
| Traffic MAT: | 64,000* per week |

* Excludes pedestrian entries to Kmart & Coles, National Pharmacies, Australia Post, and Australian Central Credit Union – which are tenancies external to the Mall.

Trade Area

- The trade area consists predominantly of blue collar and white collar workers from nearby businesses.
- The primary catchment area includes Port Adelaide, Queenstown, Rosewater, Alberton, Ottoway, Gillman and continues through the peninsular of Outer Harbour.

- The Newport Quays development has stimulated economic growth and will also have a dramatic impact on the Centre. Only a 5 minute drive from the centre, the development is a \$1.5 billion project and it anticipated to generate \$720 million worth of residential and commercial redevelopment in the precinct, which will increase retail spending, plus change the current demographic profile.
- The development will eventually accommodate 4000 people and 2000 new dwellings, creating a further 2000 jobs after completion.

Customer Profile

- The average age of residents: 39 – 54 yrs
- The average household size: 2.4 person
- Occupations: predominantly suburban blue collar and mid status suburban worker (white collar)
- Household / Landlord type: rented
- Population: 105,000

Source: Australian Bureau of Statistics 2006

*Note: as previously mentioned the demographics of the Port is currently changing and will continue to throughout re-development of the area.



experience the lifestyle

Site Map & Tenancy List

- 1/2 Savings & Loans Credit Union
- 3 Adelaide Bank
- 4 Grandma's Country Kitchen
- 5 Jewellery & More
- 6 Laubman & Pank
- 6A House of Lords
- 6B Vacant
- 7 Coles / Kmart
- 7A Heng Heng Chinese Gourmet
- 7B Mega Wraps
- 7C Vacant
- 8 Woolworths
- 8A Australia Post
- 9 Australian Central Credit Union
- 10 The Reject Shop
- 11A/B Pt Adelaide Paper Shop
- 11C Jetset Travel – Pt Adelaide
- 12 National Pharmacies
- 12A Vacant (formerly Trinity Medical Centre)
- 12C National Pharmacies Optical
- 13/14 Vacant
- 15 Game Traders
- 16 IMVS
- 17 Portside Photos
- 18 Wendy's Supa Sundaes
- 19 Smokemart
- 20 Vacant
- 21 Pt Canal Meats
- 22 Mayfair Bakery
- 23 Liquorland
- K1 Coffee Kick
- K2 Pt Canal Shoe Repairs

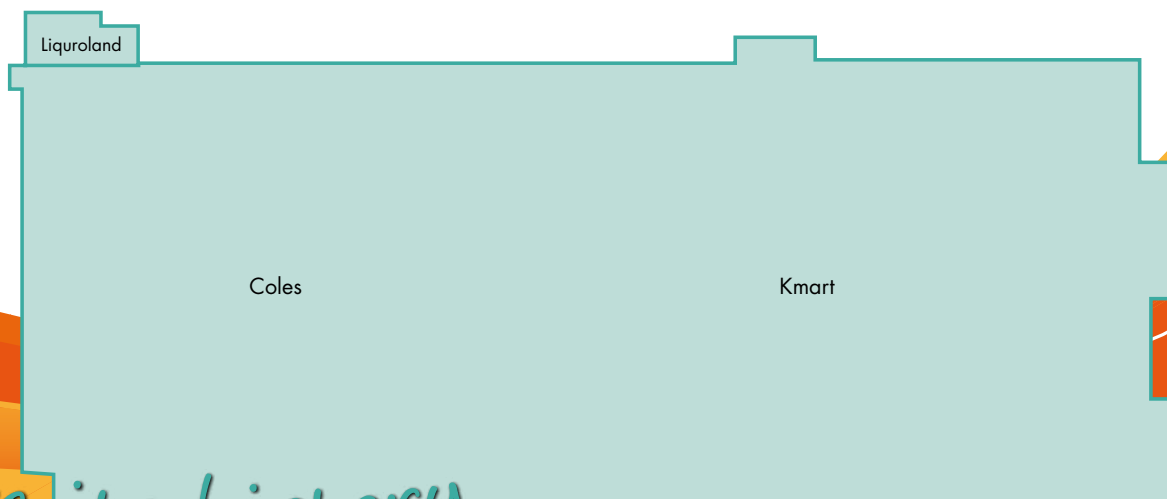
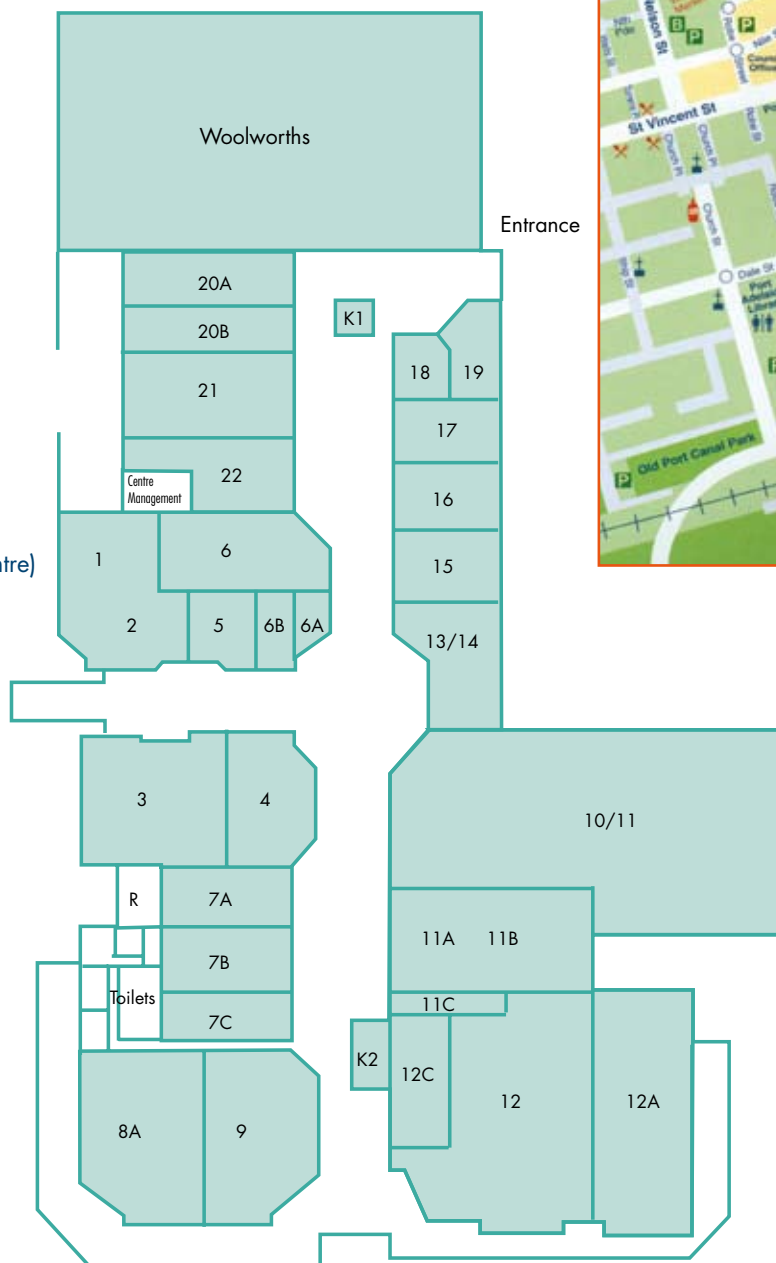

capture its history



Your Centre for Convenient Shopping

Your Centre for Delicious Food

Coffee Kick
Grandma's Country Kitchen
Heng Heng Gourmet
Coles
Liquorland
Mayfair Bakery
Megawraps
Port Canal Meats
Wendys
Woolworths

Your Centre for Great Services

Laubman & Pank
National Pharmacies
National Pharmacies Optical
Port Adelaide Paper Shop
Port Canal Shoe Repairs
Kmart
Adelaide Bank
Australia Post
Australian Central Credit Union
Savings & Loans

Your Centre for that Perfect Gift

Reject Shop
Gametraders
Jewelry & More
Smokemart
House of Lords
Jetset Travel



Your Centre for Convenient Shopping - Open 7 Days
200 Commercial Road, Port Adelaide SA 5015
p 8240 0844 www.portcanalshoppingcentre.com.au



PRECISION
GROUP